



SECTION 01 - 01

Scale : 1 : 100.

**Scottish Borders Council
Town And Country
Planning (Scotland) Act
1997**

REFUSED

subject to the
requirements of the
associated Decision
Notice

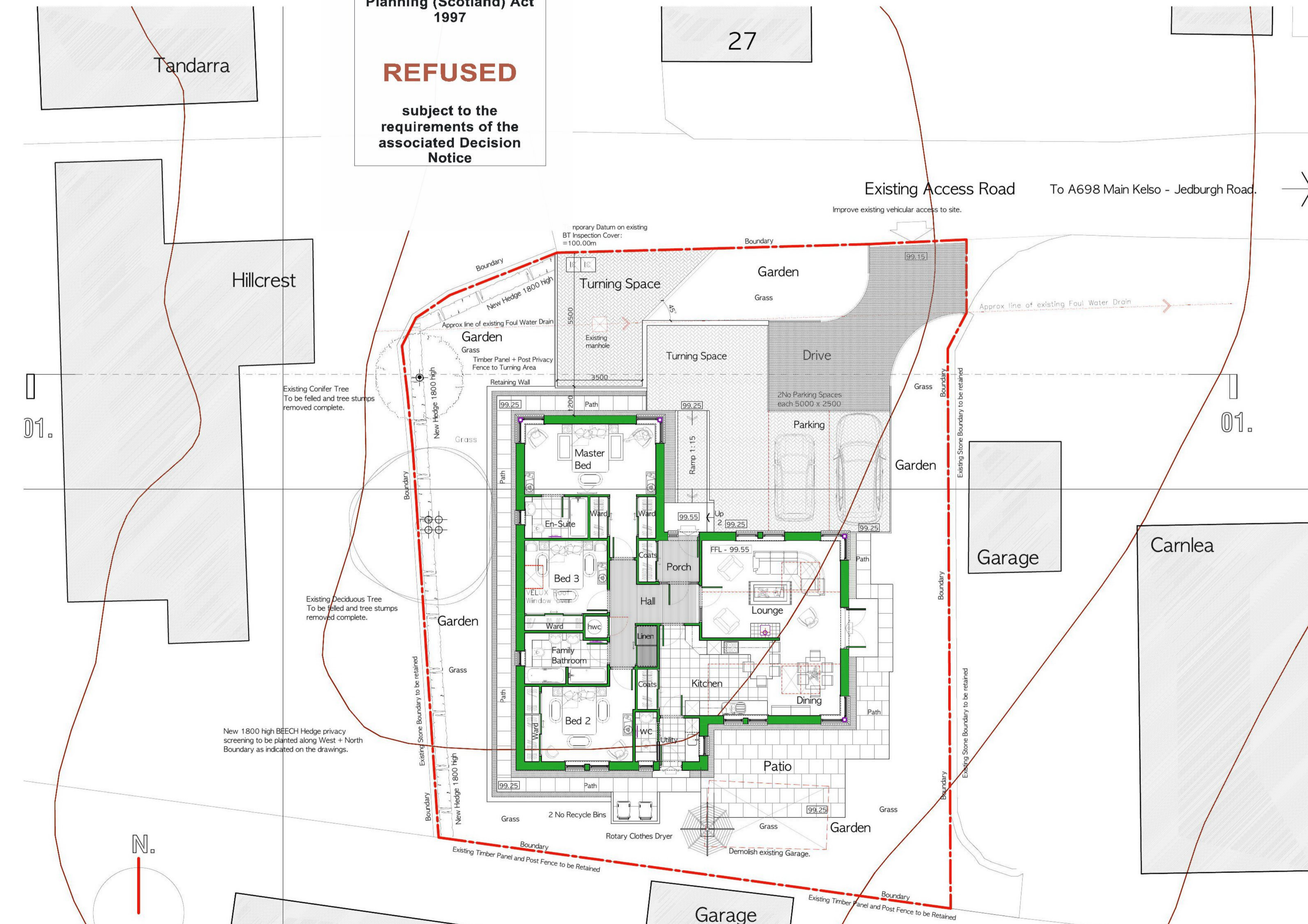

SITE WORKS:
HARD LANDSCAPING

**DRIVEWAY, PARKING, TURNING SPACE, RAMP and FOOTPATHS
PERMEABLE CONSTRUCTION**

SS. Excavations:
Excavate for Drive, Parking, Turning Space and footpaths as shown on drawings.
Supply and install precast concrete edgings to BS EN 1340 size 150 x 50 x 915mm to Drive, Parking and Turning Space, as indicated on the drawings.
Bedding and backing of units, either of the following:
Bedded on mortar laid on hardened concrete base. Bedding mortar allowed to set and units secured with a continuous haunching of concrete.
Bedded on fresh concrete races to BS 7533-6, secured with backing concrete cast monolithically with concrete race.
Concrete for foundations and haunching:
Standard to BS 8500-2.
Designated mix: Not less than GEN10 or standard ST1 or better, low workability.
Mortar bedding 1:3 cement sand as section Z2.1.
Bed thickness 12 - 40mm.

GRAVEL DRIVE, PARKING + TURNING SPACE:-
From gravel drive with concrete edges as indicated on the plans.
Excavate to vehicular access road and footpaths as shown on drawings, to depths required for sub-base thickness as below:-
Sub-base to Drive, Parking and Turning areas be minimum 150mm thick granular sub-base.
Sub-base to footpaths to be minimum 100mm thick granular sub-base.
Granular material:
Crushed rock (other than argillaceous rock) or quarry waste with not more binding material than is required to help hold the stone together.
Natural gravel.
Natural sand.
No frost susceptible material.

Execution:-
Preparation/compacting of subgrades:
Soft or damaged areas: Excavate and replace with sub-base material, compacted in layers 300mm thick (maximum).
Compaction: Thoroughly, by roller or other suitable means, adequate to resist subsidence or deformation of the subgrade during construction and of the completed pavings when in use. Take particular care to compact fully at intrusions, perimeters and where local excavation and backfilling has taken place.
Compaction of sub-base:
Preparation: Remove loose soil, rubbish and standing water.
Laying: Spread and level in layers. As soon as possible thereafter thoroughly compact each layer.
After compaction and immediately before overlaying, the sub-base must be uniformly well closed and free from loose material, cracks, ruts or hollows.
Blinding:-
Finish: Vibrate to provide a close, smooth surface.
Protection:-
Sub-bases: As soon as practicable, cover with subsequent layers, specified elsewhere.
Prevent degradation by construction traffic, construction operations and inclement weather.
Geotextile sheet:
Lay geotextile sheet overlay, over blinding course, fit neatly at edge restraints and other features. e.g. drainage fittings, channels, manholes and kerbs.
Width: 1000mm (minimum).
FINISHES:-
DRIVE
Bonded chippings: Standard: to BS EN 13043.
General: Loose laid and raked to a uniform 50mm thickness
PARKING, TURNING AREAS and RAMP:-
Parking + Turning Areas + Ramp
To be finished with Permeable finish, MARSHALLS Driveline Piora (colour Charcol) size 200 x 100 x 60mm thick sets laid in a regular pattern, or similar approved. Laid on a 50mm thick laying course 6-2mm open graded crushed rock.
Compaction:
Compaction should be undertaken with a plate vibrator. Prior to final compaction of the surface, joints should be filled with the same grading of materials as that used for the laying course.
PERMEABLE Areas to perimeters of HOUSE and PATHS:
Minimum 200mm wide, positioned as indicated on site layout.
Formed with minimum 300mm thick recycled crushed stone to dust, on imported graded 40mm to dust and finished with 50mm thick gravel, to drive as indicated, colour to be agreed.

PAVING:
Including FOOTPATHS and PATIO AREAS
Form concrete flag paving with concrete edges as indicated on the plans.
Standards: Concrete flags 900x600x38mm to BS EN 1338.
Laying course sand or sand bedded concrete flags to BS 7533-4 maintained at even moisture content that will give maximum compaction.
Execution:-
Sub-base: 100mm thick all as specified above.
Blinding: all as above.
Geotextile sheet: all as above.
Laying pavings general: Appearance, smooth and even with regular joints and accurate to line, level and profile.
Falls: To prevent ponding.
Bedding of paving units: Firm so that no rocking or subsidence does not occur or develop.
Bedding/ Laying course: Consistently and accurately graded, spread and compacted to produce uniform thickness and support for paving units.
Slopes: Lay paving units upwards from bottom of slopes.
Paving units: Free of mortar and sand stains.
Cutting: Cut units cleanly and accurately, without spalling, to give neat junctions with edgings and adjoining finishes.
PROTECTION:-
Cleanliness: Keep paving clean and free from mortar droppings, oil and other materials likely to cause damage.
Materials storage: Do not overload pavings with stacks of materials.
Handling: Do not damage paving unit corners, arrises or previously laid paving.
Access: Restrict access to paved areas to prevent damage from site traffic and plant.

NOTES :
DO NOT SCALE from this drawing.
Contractors must verify all dimensions on site before setting out, commencing work, ordering materials or making any shop drawings.
This drawing and design is for use solely in connection with the project described below.
COPYRIGHT :-
This drawing is the copyright of Patterson ARCHITECTURE, and must not be copied, re-issued or loaned without prior written consent of Patterson ARCHITECTURE.
Any discrepancies and/or conflicting information or specified is to be notified to Patterson ARCHITECTURE, prior to construction on site.
Construction should only proceed from drawings issued for construction purposes unless prior written consent is obtained.
Should any site personnel, or those employed to carry out the works on their behalf choose alternative materials, or components to those specified on Patterson ARCHITECTURE drawings, without prior written agreement then they do so at their own risk.
The information contained in this drawing is representational and has been compiled, from a dimensional survey only and does not warrant nor certify the structure of the buildings or neighbouring structures at the time of construction.
The contractor is to visit the site to make himself acquainted with the building's and surroundings and undertake any investigation work or make all allowances to ensure that a full and final quotation for the works will be submitted, taking into account all eventualities.
Failure to do so will be at the contractors own risk and no additional payments shall be countenanced for any amendments to the work.
The contractor is to carry out all works in full compliance with the Health and Safety Commission's Approved Code of Practice 'Managing Construction for Health and Safety' and Construction (Design and Management) Regulations 1994.
All work and working practices on the site shall be carried out in accordance with the above and to ensure that there is no risk to the site operatives, visitors or public.
The contractor is to include all preliminary allowances to cover the prevention of accidents and injury.
All works are to be carried out to comply with manufacturers, suppliers and industry guidelines, local authority regulations, good standards, fire safety recommendations, specialist subcontract recommendations and services supply and installation regulations. All manufacturers literature is to be kept on site. Provide all relevant guarantees in duplicate for presentation to the client.
Allow all necessary attendance and liaison with CA's (and CA personnel) specialist subcontractor trades. Ensure all notifications are submitted to the Local Authority.
Building Control and submit materials as required to the local Authority Planning Department.
Carefully examine the drawings and notify any discrepancies to the CA for instruction prior to proceeding.
Check all dimensions on site prior to ordering materials and notify any discrepancies to the CA for instruction prior to proceeding.

No Responsibility For Any Error Or Omission In This Specification Will Be Recognised Unless Brought To The Attention Of The Client Or His Agent Prior To Signing The Contracts.
This drawing is for PLANNING PERMISSION PURPOSES only and is not a Construction drawing. Drawing to be read in conjunction with drawing numbers PDK-20-137-006 to 010.

| | | | |
|----|------------|-----|--|
| 2. | 02-02-2021 | JHP | Form Turning Space at Head of Access Road. |
| 1. | 19-01-2021 | JHP | Amendments for Planning. |

16, Riverside View, KELSO, Scottish Borders, TD5 7UG.
T: 01573 226553.
M: 07850 327677.
LOWESTOFT, Suffolk, England:
T: 01502 806989.
E: info@patterson-architecture.co.uk



www.patterson-architecture.co.uk

Project Address:
Proposed Bungalow at:
27, Main Street,
HEITON, Kelso,
Roxburghshire,
TD5 8JR.

Client Name:
for Mr + Mrs Graham
Drawing Title:
Planning:
SITE Plan + SECTION 01-01

| | | |
|--------------------------------------|---------------------|-----------------|
| Drawn By: | Project Ref Number: | |
| John H Patterson. | PDK-20-137 | |
| Date: | Scale: | Drawing Number: |
| 19th January 2021 | 1:100 @ A1 | 009 |
| All dimensions are in millimeters | Suffix: | |
| All dimensions to be checked on site | 01 02 | |

Drawing List:

| Drawing No: | Drawing TITLE: | Scale: | Date: | Amended: |
|----------------|--|--------------------|------------|------------|
| PDK-20-137-004 | FLOOR Plan + NORTH Elevations. | 1:50 @ A1. | 31-10-2020 | 19-01-2021 |
| PDK-20-137-007 | SOUTH + EAST + WEST Elevations. | 1:50 @ A1. | 31-10-2020 | 19-01-2021 |
| PDK-20-137-008 | ROOF Plan + Location Plan | 1:50 + 1:1250 @ A1 | 31-10-2020 | 19-01-2021 |
| PDK-20-137-009 | SITE Layout Plan + SECTION Through Site. | 1:100 @ A1. | 31-10-2020 | 19-01-2021 |
| PDK-20-137-010 | Privacy + Overlooking Plan. | 1:100 @ A1. | 19-01-2021 | |

Reproduced from Superplan Data by permission of Ordnance Survey® on behalf of the Controller of Her Majesty's Stationery Office. All rights reserved.
Licence No: 100022432.